

BLOCK 9 LOT 1
 SCTM 1000-5-1-12.3
 AREA=1.33± ACRES
 (58,155± S.F.)
 "VACANT LOT"

BLOCK 8 LOT 11
 SCTM 1000-5-2-6
 AREA=1.60± ACRES
 (69,690± S.F.)

S: 784.13
 W: 1714.78

S: 892.33
 W: 1612.64

LEGEND

- PROPERTY LINE
- ABUTTERS LINE
- EDGE OF PAVEMENT
- EDGE OF GRAVEL
- NOW OR FORMERLY
- BOUNDARY POINT
- IRON MONUMENT
- MERESTONE

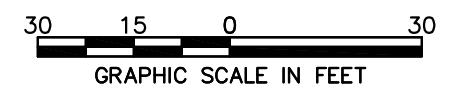

QUALITY CONTROL CERTIFICATION		
GROUP	REVIEWED	DATE
PROJECT MANAGER		
SURVEY		
ENVIRONMENTAL		
CIVIL		
STRUCTURAL		
ARCHITECTURAL		

MAP REFERENCES

- PLAN MADE FOR MARY DENNY SCOTT WRAY, BLOCK 8, LOT 11, FISHERS ISLAND, NEW YORK, SCALE: 1"=40', DATE: NOVEMBER 26, 1985, BY CHANDLER, PALMER & KING
- SURVEY MAP OF PROPERTY TO BE CONVEYED BY ELIZABETH C. NOYES TO MARY WRAY, JAMES REID, BUFORD SCOTT REID, M BAGLEY REID, BLOCK 9, LOT 1, FISHERS ISLAND, NEW YORK, SCALE: 1"=40', JULY 1992, BY CHANDLER, PALMER & KING

NOTES

- THIS SURVEY WAS PREPARED FOR THE PARTIES AND PURPOSE INDICATED HEREON. ANY EXTENSION OF THE USE BEYOND THE PURPOSED AGREED TO BETWEEN THE CLIENT AND THE SURVEYOR EXCEEDS THE SCOPE OF THE ENGAGEMENT.
- IT IS A VIOLATION OF THE STATE EDUCATION LAW FOR ANY PERSON, UNLESS ACTING UNDER THE DIRECTION OF A LICENSED LAND SURVEYOR, TO ALTER AN ITEM IN ANY WAY.
- ONLY COPIES OF THIS SURVEY MARKED WITH THE LAND SURVEYOR'S SIGNATURE AND AN ORIGINAL EMBOSSED OR INK SEAL ARE THE PRODUCT OF THE LAND SURVEYOR.
- COORDINATE DISTANCES ARE MEASURED FROM U.S. COAST AND GEODETIC SURVEY TRIANGULATION STATION "EAST END 2"
- SITE IS IN THE TOWN OF SOUTHOLD, COUNTY OF SUFFOLK TAX MAP 1000, SECTION 005, BLOCK 2, LOT 6 & BLOCK 1, LOT 12.3.
- SITE IS LOCATED IN ZONING DISTRICT R-120.

CERTIFIED TO:

J. HERBERT OGDEN, JR.
 REBECCA OGDEN
 WELLS FARGO BANK, N.A.
 FIDELITY NATIONAL TITLE INSURANCE COMPANY

IN ACCORDANCE WITH THE MINIMUM STANDARDS FOR TITLE SURVEYS OF THE NEW YORK STATE LAND TITLE ASSOCIATION.

TITLE NO.
 LOT 1000-5-2-6- 7404-006468
 LOT 1000-5-1-12.3- 7404-006469

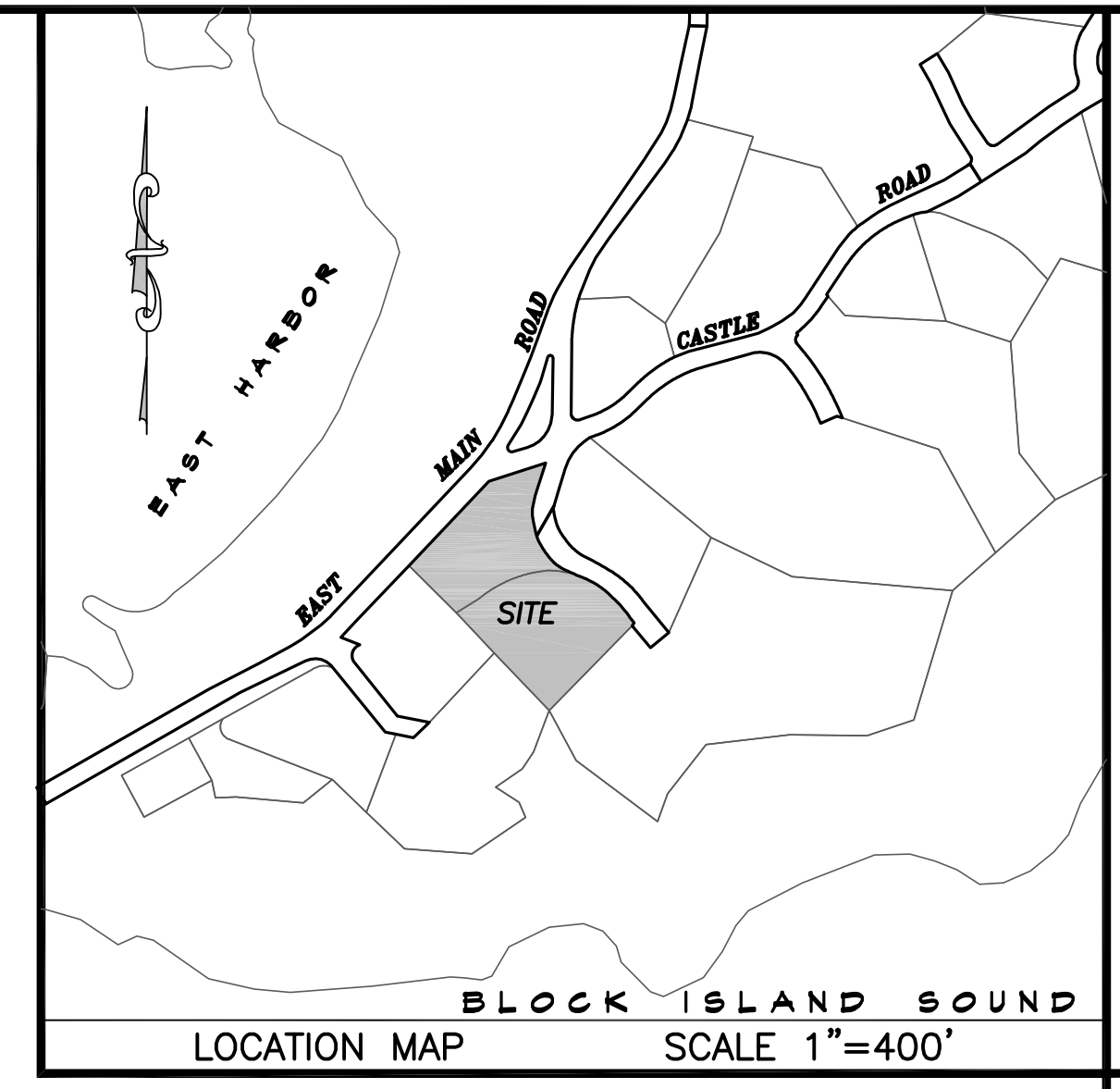

CME ASSOCIATES Engineering, Land Surveying & Architecture, PLLC
formerly Chandler, Palmer & King

33 Wilbur Cross Way, Meriden, CT 06468
 101 East River Drive, 1st Floor
 East Hartford, CT 06108
 888-291-3227 | www.cmeengineering.com

SURVEY MAP
 PROPERTY TO BE CONVEYED TO
J. HERBERT OGDEN, JR. & REBECCA OGDEN
 EAST MAIN ROAD & 1925 CASTLE ROAD
 FISHERS ISLAND, NEW YORK

JOB DATA		REVISIONS	
PROJECT	NO.	DATE	DESCRIPTION
2019847			
BOOK NO.	FI		
DESIGNED			
DRAWN	ZBC		
CHECKED	RHS/CB		
COGO FILE	2019847 ALL		
FILE	2019847_BND.dwg		

DATE: 11/11/2019
 SCALE: 1" = 30'
 PROJECT: #2019847

SHEET
 1 OF 1